

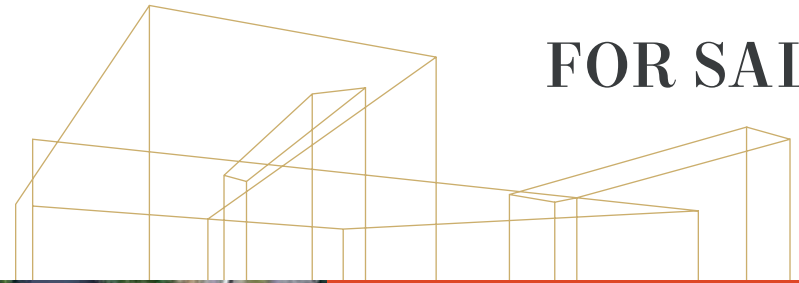

# Kent Food Manufacturing Building

19039 62ND AVENUE S, KENT, WA

## FOR SALE



Ideally located in the heart of Kent Valley

- 15,392 SF**
- BTS** office
- FLOOR** drains
- HEAVY** power
- NEW** roof
- 1.01** acre lot
- M1** zoning
- FOUR** minutes from I-5
- ONE** dock position
- TWO** grade-level doors

**FOR SALE**

# Kent Food Manufacturing Building

19039 62ND AVENUE S, KENT, WA



**15,392**

TOTAL SF

**BTS**

OFFICE

**M1**

ZONING

KRAIG HEETER, SIOR

206.248.7313

[kraig.heeter@kidder.com](mailto:kraig.heeter@kidder.com)

KIDDER.COM

This information supplied herein is from sources we deem reliable. It is provided without any representation, warranty, or guarantee, expressed or implied as to its accuracy. Prospective Buyer or Tenant should conduct an independent investigation and verification of all matters deemed to be material, including, but not limited to, statements of income and expenses. Consult your attorney, accountant, or other professional advisor.

**km** Kidder Mathews

**FOR SALE**

# Kent Food Manufacturing Building

19039 62ND AVENUE S, KENT, WA

## Floor Plan

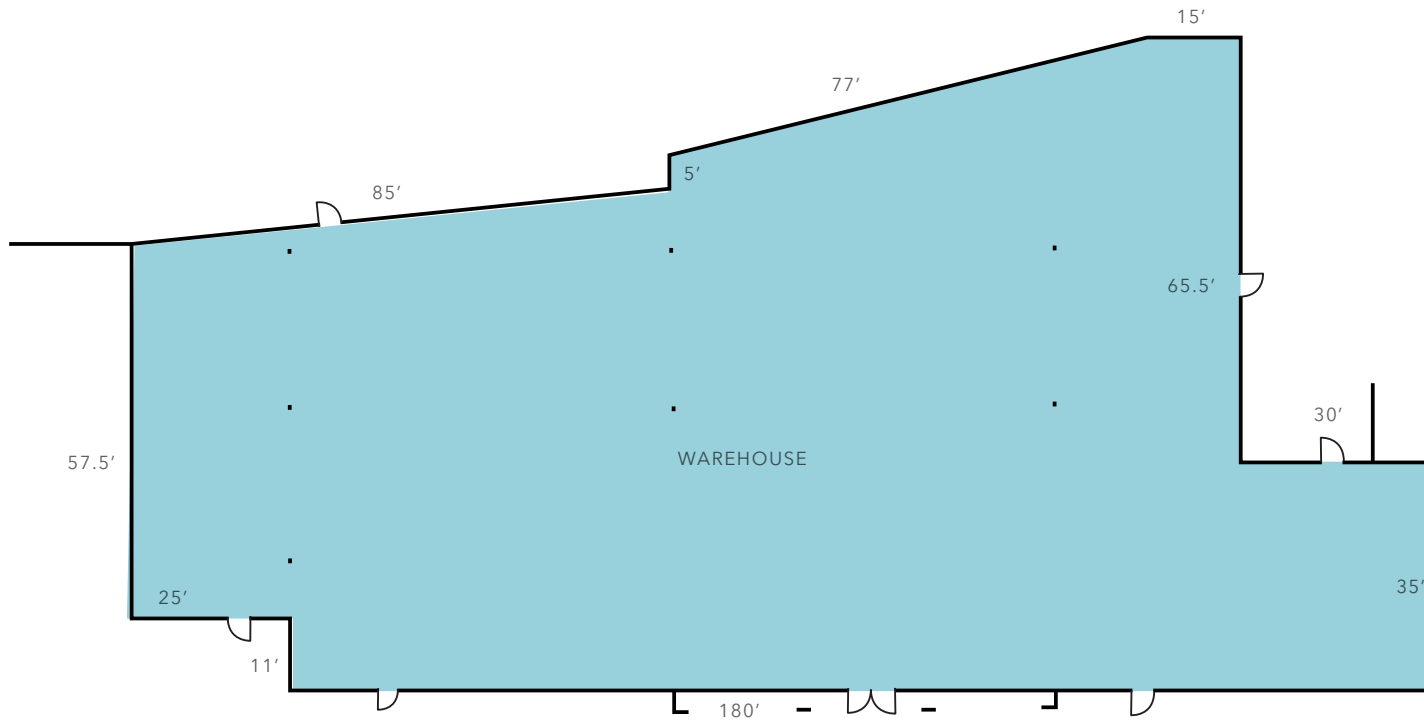

**15,392**

TOTAL SF

**ONE**

DOCK POSITION

**TWO**

GL DOORS

**KRAIG HEETER, SIOR**

206.248.7313

[kraig.heeter@kidder.com](mailto:kraig.heeter@kidder.com)

**KIDDER.COM**

This information supplied herein is from sources we deem reliable. It is provided without any representation, warranty, or guarantee, expressed or implied as to its accuracy. Prospective Buyer or Tenant should conduct an independent investigation and verification of all matters deemed to be material, including, but not limited to, statements of income and expenses. Consult your attorney, accountant, or other professional advisor.

