



**FOR SALE  
OR LEASE**

# Tierney Electric

7901 SEVENTH AVENUE SOUTH, SEATTLE, WA



## Excellent South Park location

**17,450** gross square feet

**MONTHLY** NNN lease rate of \$16,000

**MEZZANINE** office includes 1,350 SF

**14'** foot clear height

**LOADING** doors include 1 grade-level and 2 dock-high

**ONE** column row

**SALE** price \$3,825,000

**AVAILABLE** now

**CHRIS CORR**  
206.248.7324  
[chris.corr@kidder.com](mailto:chris.corr@kidder.com)

**JIM KIDDER, SIOR**  
206.248.7328  
[jim.kidder@kidder.com](mailto:jim.kidder@kidder.com)

**KIDDER.COM**

**\$3.825M**

**SALE PRICE**

**07/01/19**

**AVAILABLE DATE**

**14'**

**CLEAR HEIGHT**

This information supplied herein is from sources we deem reliable. It is provided without any representation, warranty, or guarantee, expressed or implied as to its accuracy. Prospective Buyer or Tenant should conduct an independent investigation and verification of all matters deemed to be material, including, but not limited to, statements of income and expenses. Consult your attorney, accountant, or other professional advisor.

**Kidder  
Mathews**

FOR SALE / LEASE

# Tierney Electric

7901 SEVENTH AVENUE SOUTH, SEATTLE, WA

07/01/19

DATE AVAILABLE

17,450

SQUARE FEET

1,350

MEZZANINE OFFICE  
SQUARE FEET

## Floor Plan

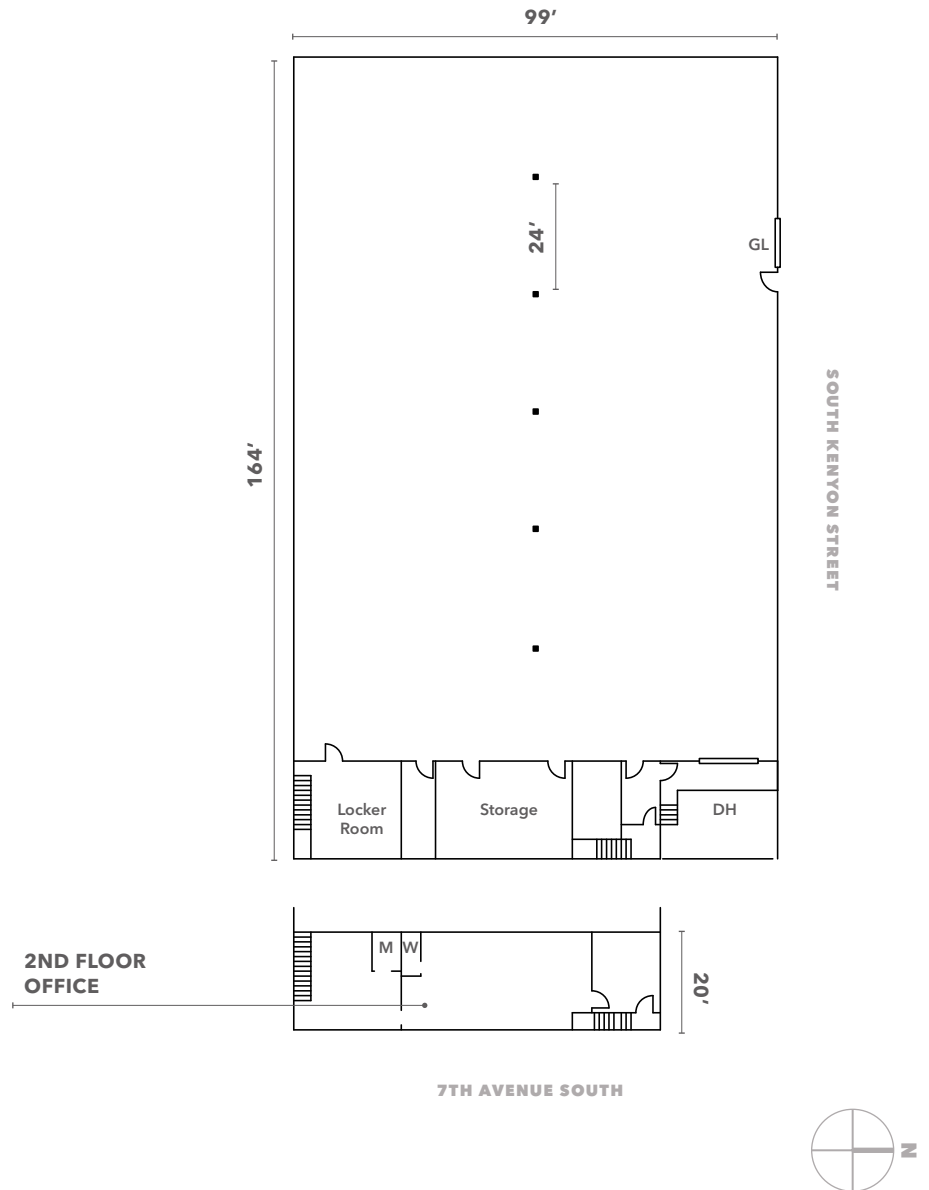

CHRIS CORR  
206.248.7324  
chris.corr@kidder.com

JIM KIDDER, SIOR  
206.248.7328  
jim.kidder@kidder.com

KIDDER.COM



This information supplied herein is from sources we deem reliable. It is provided without any representation, warranty, or guarantee, expressed or implied as to its accuracy. Prospective Buyer or Tenant should conduct an independent investigation and verification of all matters deemed to be material, including, but not limited to, statements of income and expenses. Consult your attorney, accountant, or other professional advisor.