

AVAILABLE

1701-1711 Center Street

Tacoma, WA

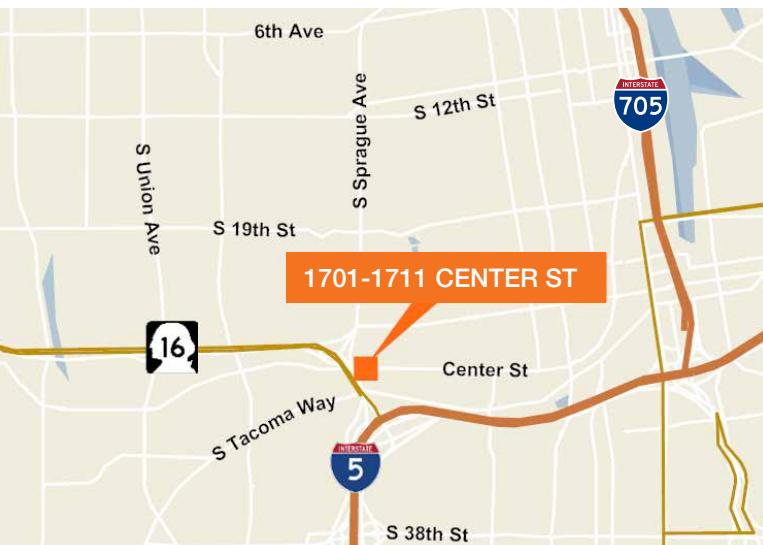

±11,610 TOTAL BUILDING SF WITH ±2,664 SF OFFICE

Zoned Light Industrial (M1)

2 tax parcels totaling ±22,000 SF

4 grade-level doors

Easy access to Downtown Tacoma, Hwy 16 and I-5

Nalley Valley location with great retail exposure

Extra parking and/or yard area

Asking: \$1,050,000.00

CONTACT

Brandon Gates

253.722.1429

bgates@kiddermathews.com



AVAILABLE

1701-1711 Center Street

BUILDING PLAN

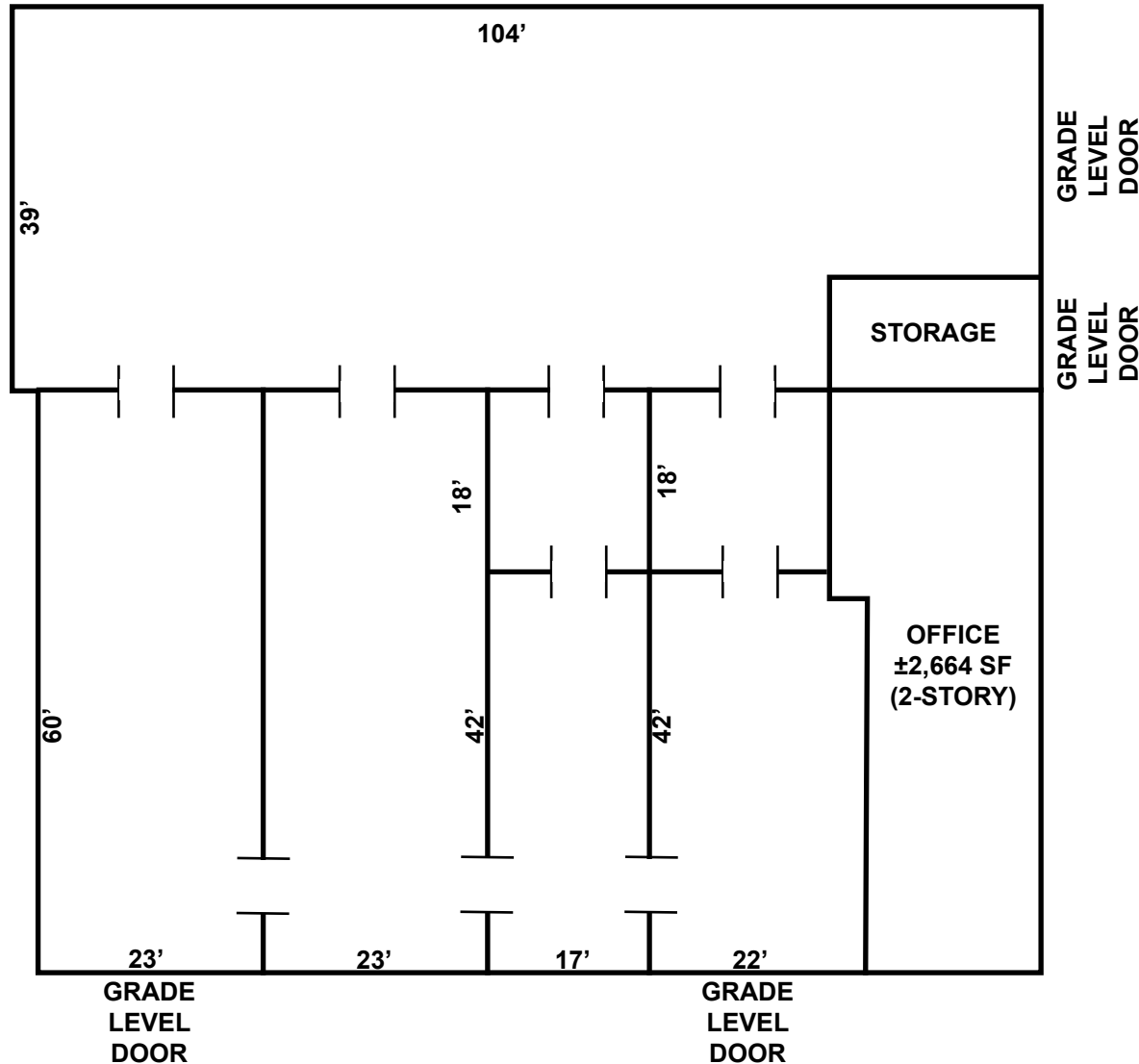

*NOT TO SCALE

CONTACT

Brandon Gates
253.722.1429
bgates@kiddermathews.com



AVAILABLE

1701-1711 Center Street

PARCEL OUTLINE



CONTACT

Brandon Gates
253.722.1429
bgates@kiddermathews.com

